

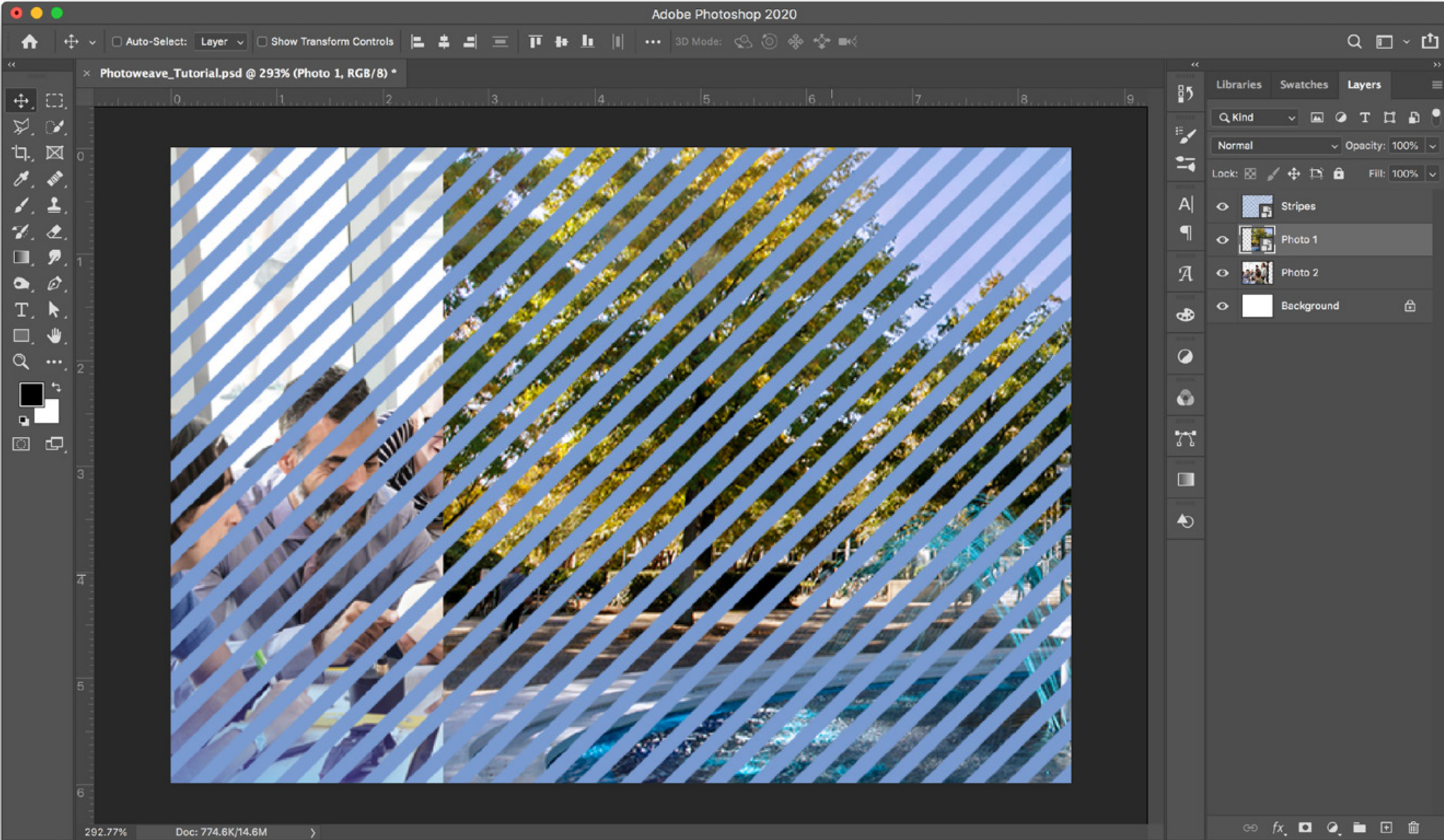

OLD DOMINION
UNIVERSITY

PHOTO WEAVE INSTRUCTIONS

Photo weaving is a photo editing technique that blends two images together using a striping pattern and layer masks in Adobe Photoshop. In this tutorial, you will learn to create a striped layer mask that will hide or reveal elements of your images to “weave” them together.



STEP 1: Create a new document in Photoshop with the dimensions for your project/image size.

STEP 2: Import two photos into Photoshop. The photos should be generally similar in size with subjects on opposite sides of the frame.

STEP 3: Import stripes from the branding guide. Name your layers accordingly.

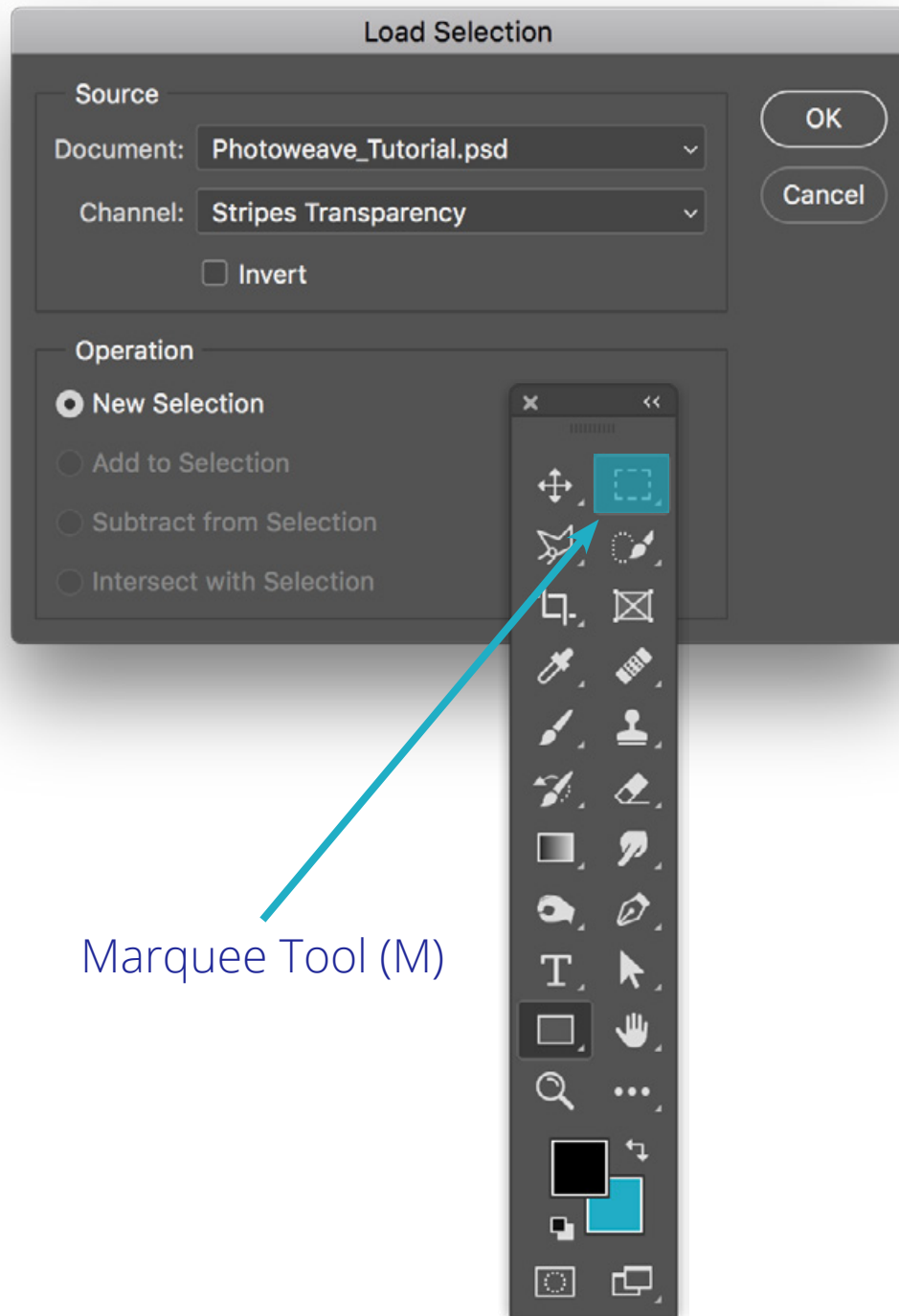

Marquee Tool (M)

STEP 4: Select the “Stripes” layer, then select the marquee tool (M).

STEP 5: Right click > “Load Selection”

STEP 6: In the Load Selection settings, “Document” should be the name of your document, “Channel” should be the name of the stripes layer. Choose “New Selection.” Hit “OK.”

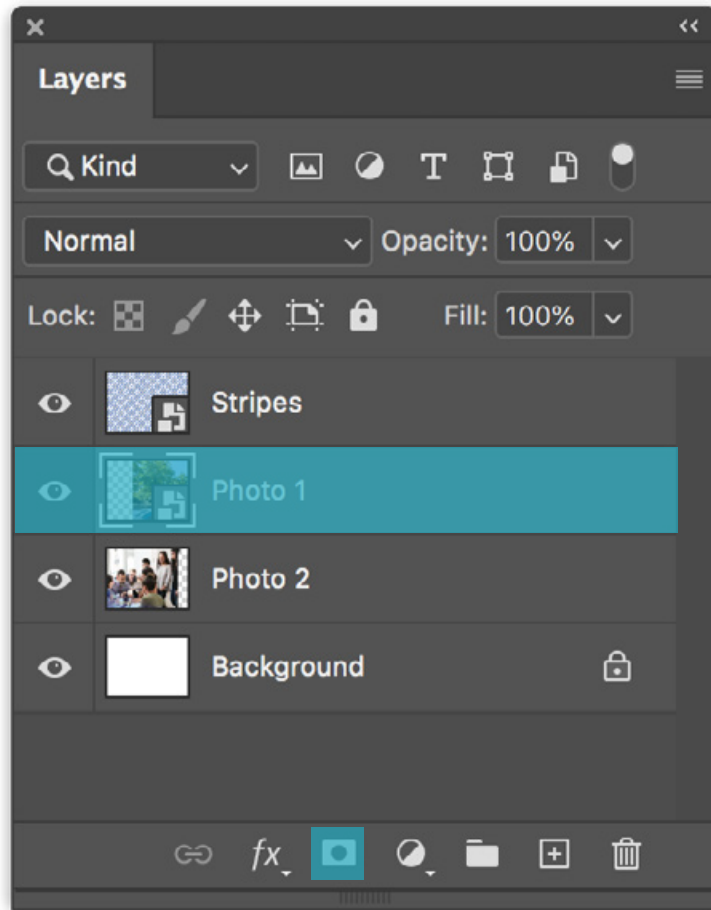

Add layer mask

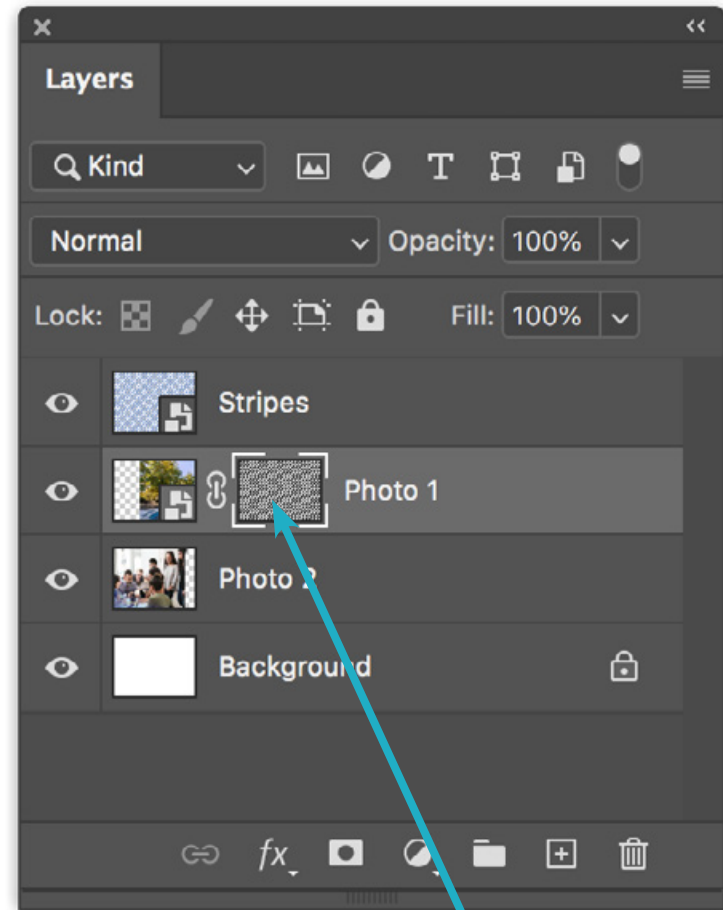

New layer mask

STEP 7: With the selection loaded (marquee lines should appear/move), select the “Photo 1” layer. Click “add layer mask.” Photo 1 should be above Photo 2 in the layers panel.

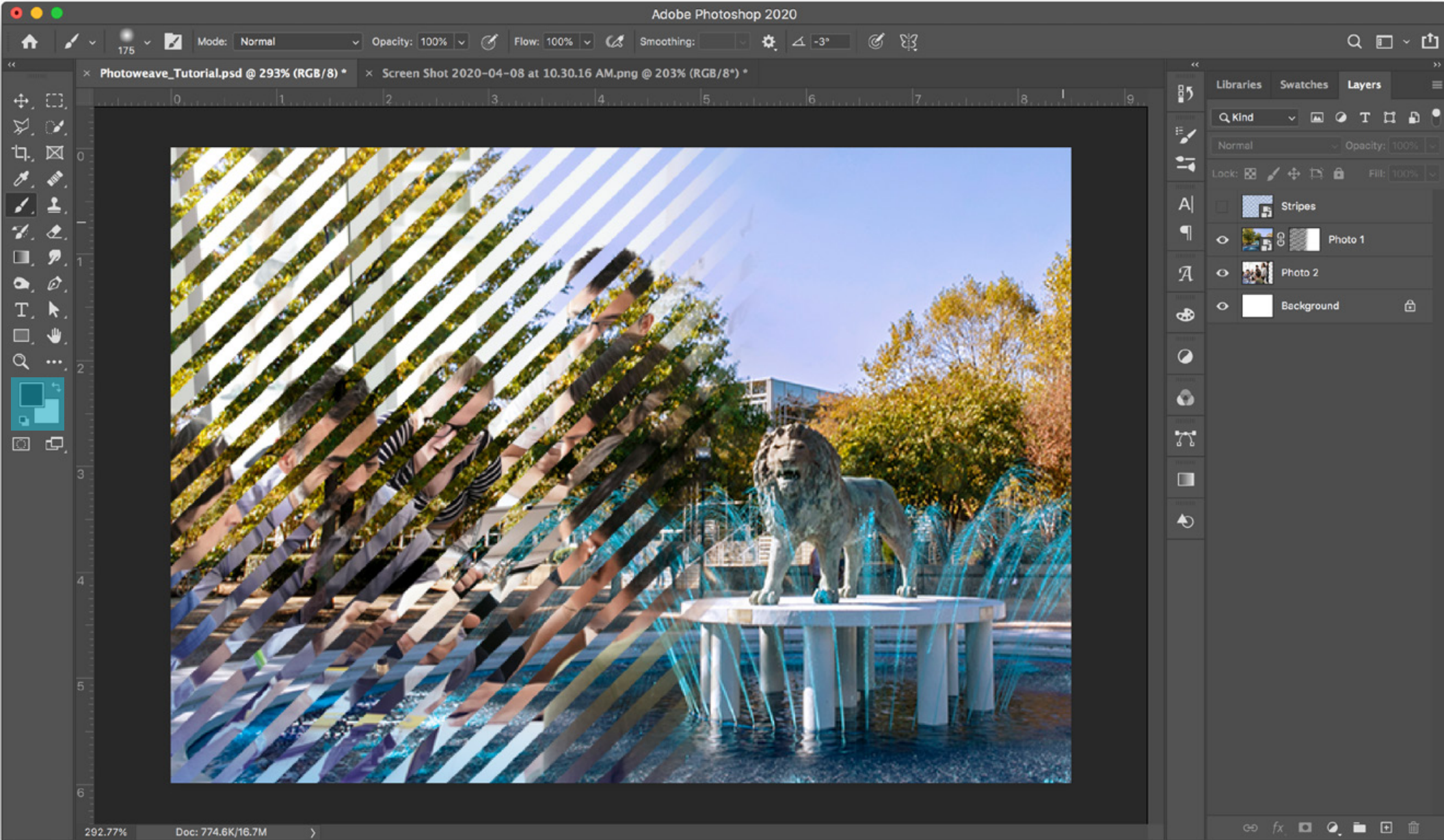

STEP 8: Hide the “stripes” layer

STEP 9: Click the layer mask on Photo 1. Select the brush tool (B) and make sure the color swatches are black and white.

STEP 10: Using the white brush, paint on the mask to reveal more of the photo (ex: on the right of Photo 1, lion photo). It is recommended to use a large brush set to 0% hardness.

Tip: When using a brush on a layer mask, a white brush reveals your image and a black brush hides your image.

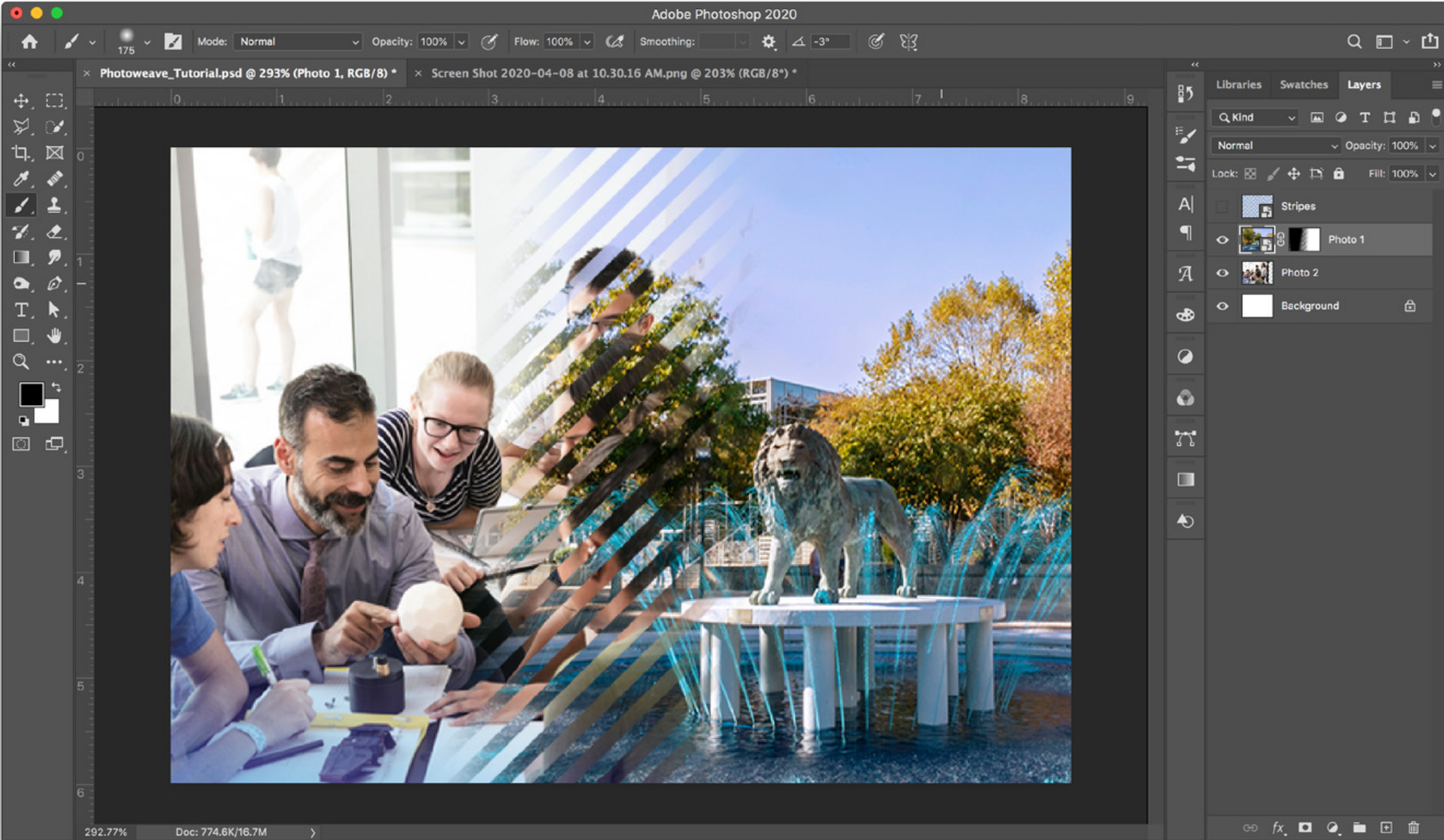

STEP 11: Using the black brush, paint on the areas of the mask you want to hide (ex: on the left of the lion photo) . This will reveal Photo 2 underneath. Your photo weave is now complete.

Photo weave variations



PHOTO WEAVE 1: This photo weave has even brush strokes on each side of the frame.



PHOTO WEAVE 2: This photo weave follows the striping pattern.

**Visit odu.edu/toolkit for
brand resources and assets.**

For questions, contact

Christen Turney
Marketing & Advertising Coordinator
Strategic Communication & Marketing
cturney@odu.edu